



RESSUSCITÉ

LA NOUVELLE CATHEDRALE NOTRE DAME DE L'ASSOMPTION

ON JANUARY 12, 2010 HAITI CHANGED FOREVER. A 7.0 MAGNITUDE QUAKE SHOOK PORT-AU-PRINCE AND ITS NEIGHBORING COMMUNITIES. IT CAME UNEXPECTEDLY, AS ALL EARTHQUAKES DO, AND LEVELED A CITY AND COUNTRY ON THAT JANUARY DAY, WHEN THE GROUND STOPPED SHAKING, THE LIVES OF OVER 300,000 HAD BEEN TAKEN. 300,000 MORE HAD BEEN INJURED, AND 1,000,000 MADE HOMELESS. 250,000 HOUSES WERE LOST. 30,000 COMMERCIAL BUILDINGS WERE DESTROYED. THE MINISTRIES, AND THEIR LEADERS, WERE GONE. THE PRESIDENTIAL PALACE WAS SEVERELY DAMAGED, AND THE CATHEDRAL, NOTRE DAME DE L'ASSOMPTION LAID IN RUIN.

THE 2012 HAITI EARTHQUAKE DID MUCH MORE THAN TAKE LIVES AND DESTROY BUILDINGS. IT RIPPED FAMILIES APART, LEFT ORPHANS IN THE STREETS, CRIPPLED AN ALREADY CHALLENGED ECONOMY, AND BROKE THE HEARTS OF MILLIONS AROUND THE WORLD. HOWEVER, UNDERNEATH THE CRUMBLD CONCRETE AND RUBBLE, LAY AN EVEN GREATER FORCE THAN ANY EARTHQUAKE COULD EVER EXERT: THE SPIRIT OF THE HAITIAN PEOPLE AND THE SUPPORT OF THE WORLD. AFTER THE SICK WERE CARED FOR, AND AFTER THOSE LOST WERE BURIED, MANY WITHOUT CEREMONY AND WITHOUT ANNOUNCEMENT, THE COUNTRY SLOWLY STARTED TO CLEAR THE DEBRIS, AND REGAIN ITS FOOTING. HAITI IS REBUILDING AND WILL CONTINUE TO REBUILD, STRONGER AND BETTER THAN IT EVER HAS BEFORE. HAITI LOOKS TO THE WORLD FOR AID, AND WE LOOK TO HAITI FOR INSPIRATION AND HOPE.

AT THE HEART OF THE REBUILDING PROCESS IS THE CATHEDRAL. WHEN SO MANY HAVE LOST, AND SO MANY ARE IN SEARCH OF ANSWERS, THE CATHEDRAL REMINDS US THAT WE ARE SURVIVORS. BECAUSE OF THIS, THE EFFORTS NEEDED TO REBUILD THE CATHEDRAL ARE PARAMOUNT. NOTRE DAME DE L'ASSOMPTION STOOD TALL AND PROUD IN THE SKYLINE OF THE CITY, ITS TWIN BELL TOWERS WERE SCALED TO THE SIZE OF THE MOUNTAINS AND THE SEAS. THEY SPOKE TO THE NATURAL WORLD NOT THE MANMADE. SO TOO, IS THE CASE IN THIS DESIGN PROPOSAL FOR A NEW CATHEDRAL FOR A NEW HAITI.

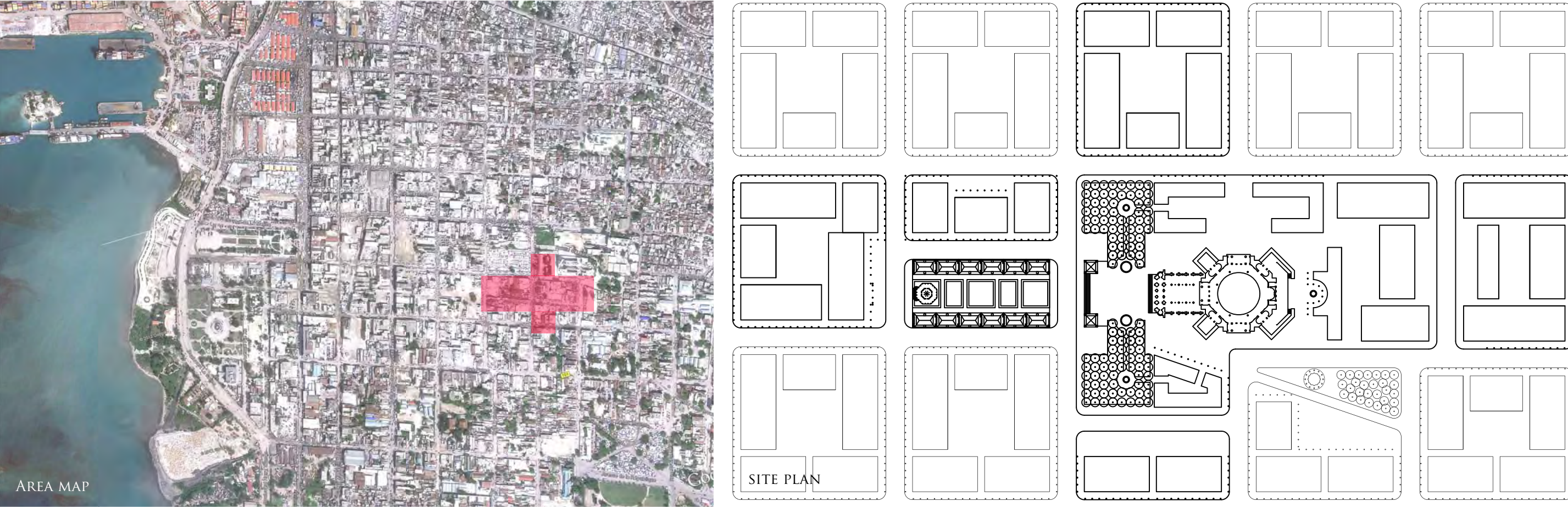

THE NEW CENTRALLY PLANNED CATHEDRAL RESTS ON A GRID OF SEISMIC ISOLATORS. THESE HELP REDUCE THE IMPACT OF LATERAL FORCES ON THE FOUNDATION. AS THE GROUND SHAKES THE GIANT BASE ISOLATORS ROCK BACK AND FORTH, ABSORBING THE MASSIVE ENERGY CREATED BY THE GROUND MOVEMENT. AS THE EARTH MOVES UNDERNEATH, THE BUILDING IS FREE TO REACT ABOVE AS THE CONNECTIONS BETWEEN THE GRADE BEAMS OF THE CATHEDRAL AND THE ISOLATORS WORK TO DAMPEN THE MOVEMENT. THIS SEISMIC TECHNOLOGY IS CELEBRATED IN THE CRYPT, STANDING SIDE BY SIDE WITH THE REMAINS OF A FOUNDATION NEVER TO BE FORGOTTEN.

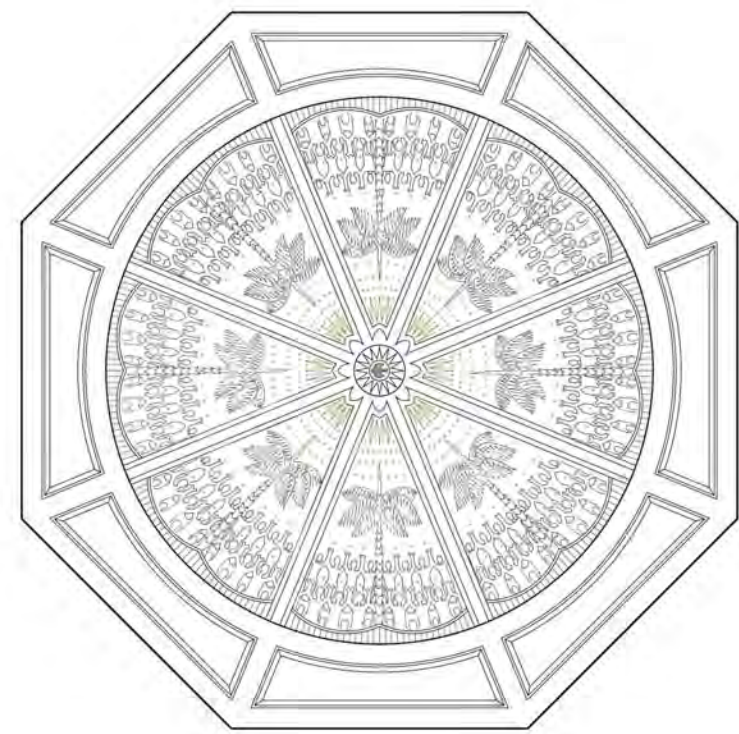
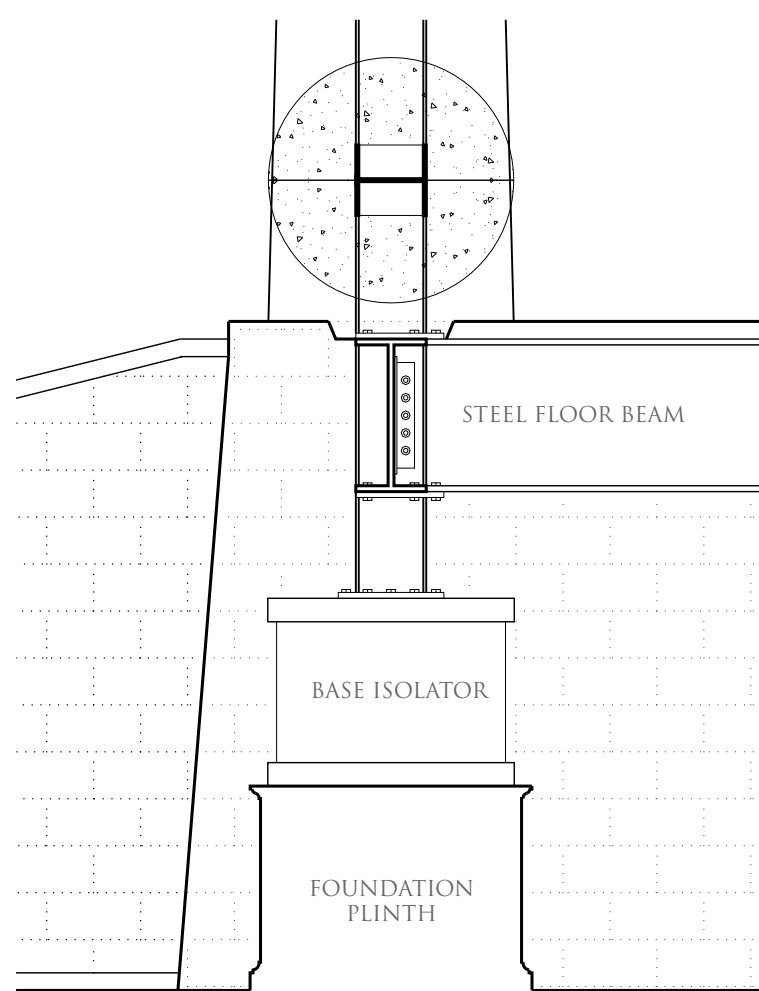

REFLECTED DOME CEILING

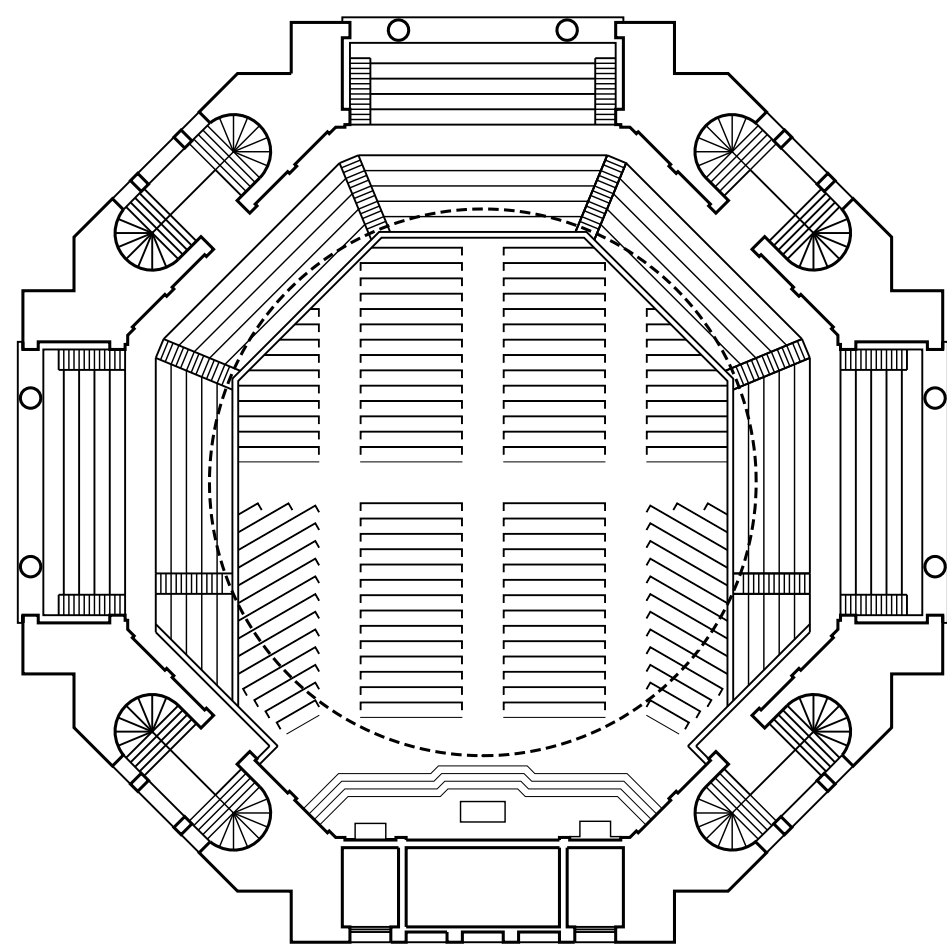

MEZZANINE PLAN

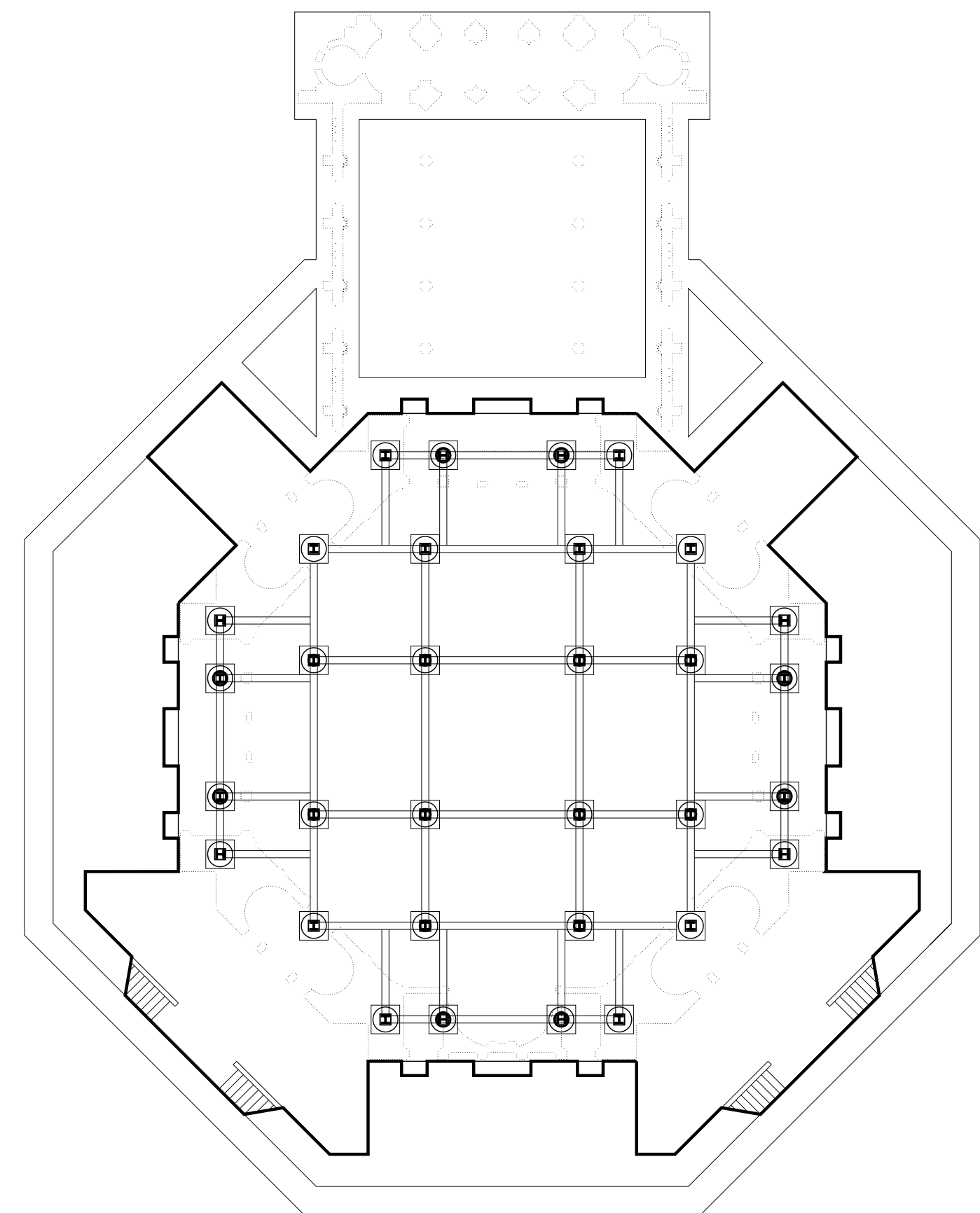

FOUNDATION PLAN

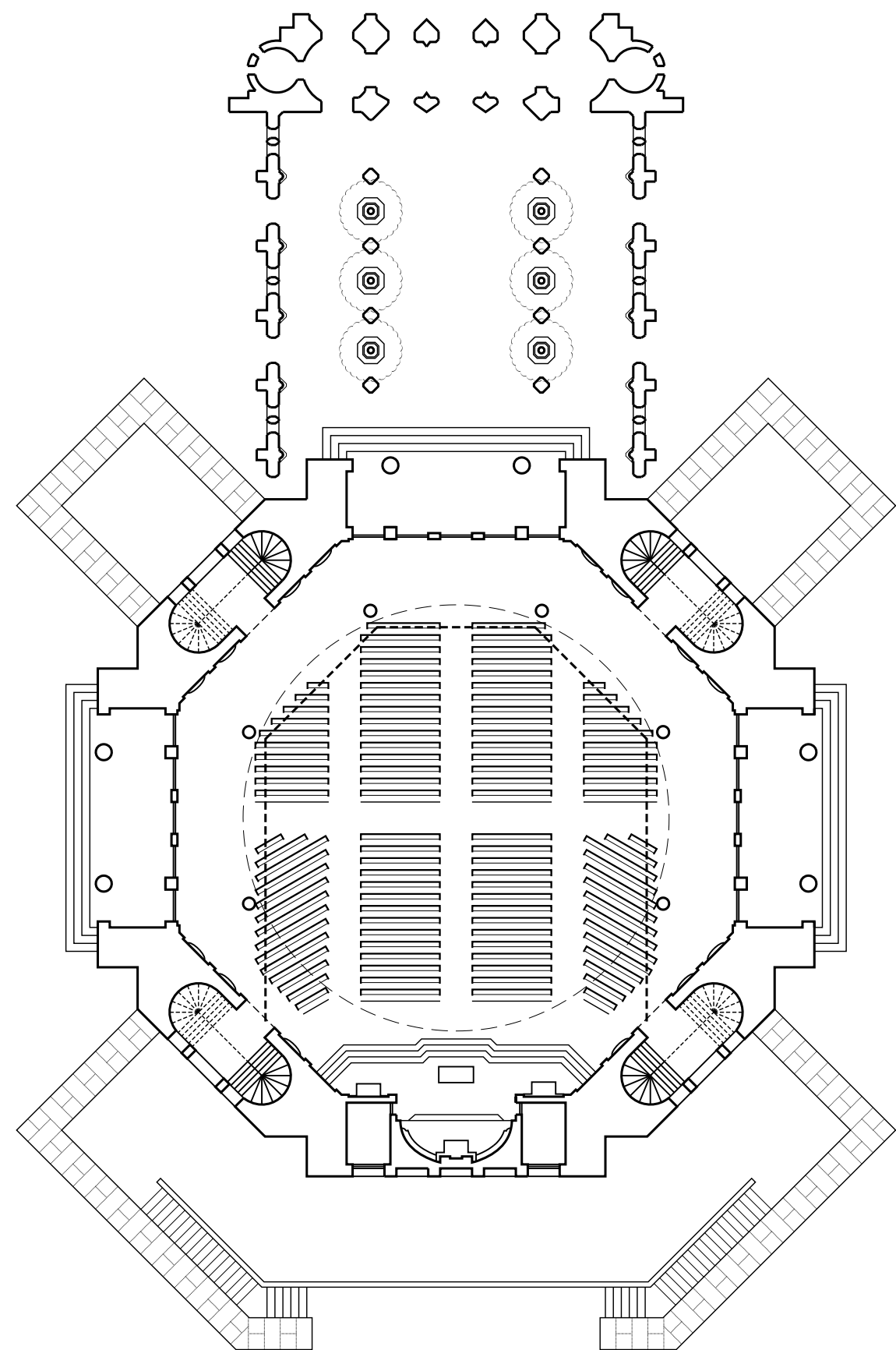

CATHEDRAL PLAN

THE PLACEMENT AND FORM OF THE NEW CATHEDRAL NOTRE DAME DE L'ASSOMPTION HOLDS MUCH SIGNIFICANCE. THE CENTER IS PLACED AT THE SITE OF THE FORMER ALTAR. MIRCEA ELIADE, AUTHOR OF THE SACRED AND THE PROFANE, SUGGESTS THAT EVERY SACRED SPACE IMPLIES A HIEROPHANY, AN EVENT IN WHICH ONE SENSORILY EXPERIENCES THE MANIFESTATION OF THE SACRED. WHEN JACOB DREAMED AT HARAN HE SAW A LADDER REACHING TO HEAVEN AND FROM THAT POINT HE DECLARED THE SPACE SACRED AND THE HOUSE OF GOD. HE PLACED A STONE AT THAT LOCATION, AND NAMED IT BETH-EL. HERE IN PORT-AU-PRINCE, THE SITE OF THE ALTAR IS SACRED AND THE GENERATIVE LOCUS OF AN "AXIS MUNDI," A VERTICAL AXIS TO COMMUNICATE BETWEEN HEAVEN AND EARTH.

AROUND THE SACRED SPACE A CENTRAL PLAN IS FORMED. THROUGHOUT THE AGES, CENTRAL PLANS HAVE BEEN HIGHLY VALUED. LEON BATTISTA ALBERTI, THE ITALIAN RENAISSANCE ARCHITECT, THEORIST, AND PRIEST CONSIDERED CENTRAL PLANS TO BE THE PERFECT GEOMETRY FOUND IN NATURE AND THE COSMOS, AND THEREFORE DIVINE. THE PROPOSED CENTRAL PLAN HERE IS AN OCTAGON. BIBLICALLY, THE NUMBER EIGHT SYMBOLIZES RESURRECTION AND REGENERATION. AS THE SEVENTH DAY WAS THE DAY OF COMPLETION AND REST, SO EIGHT WAS OVER AND ABOVE THIS PERFECT COMPLETION, AND WAS, INDEED, THE FIRST OF A NEW SERIES. THE LOCUS OF A NATION'S HOPE FAITH AND REGENERATION LIES WITHIN THESE EIGHT WALLS AND RISES TO HEAVEN. HERE IS WHERE THE NEW ERA OF HAITI SYMBOLICALLY AND LITERALLY COMMENCES.

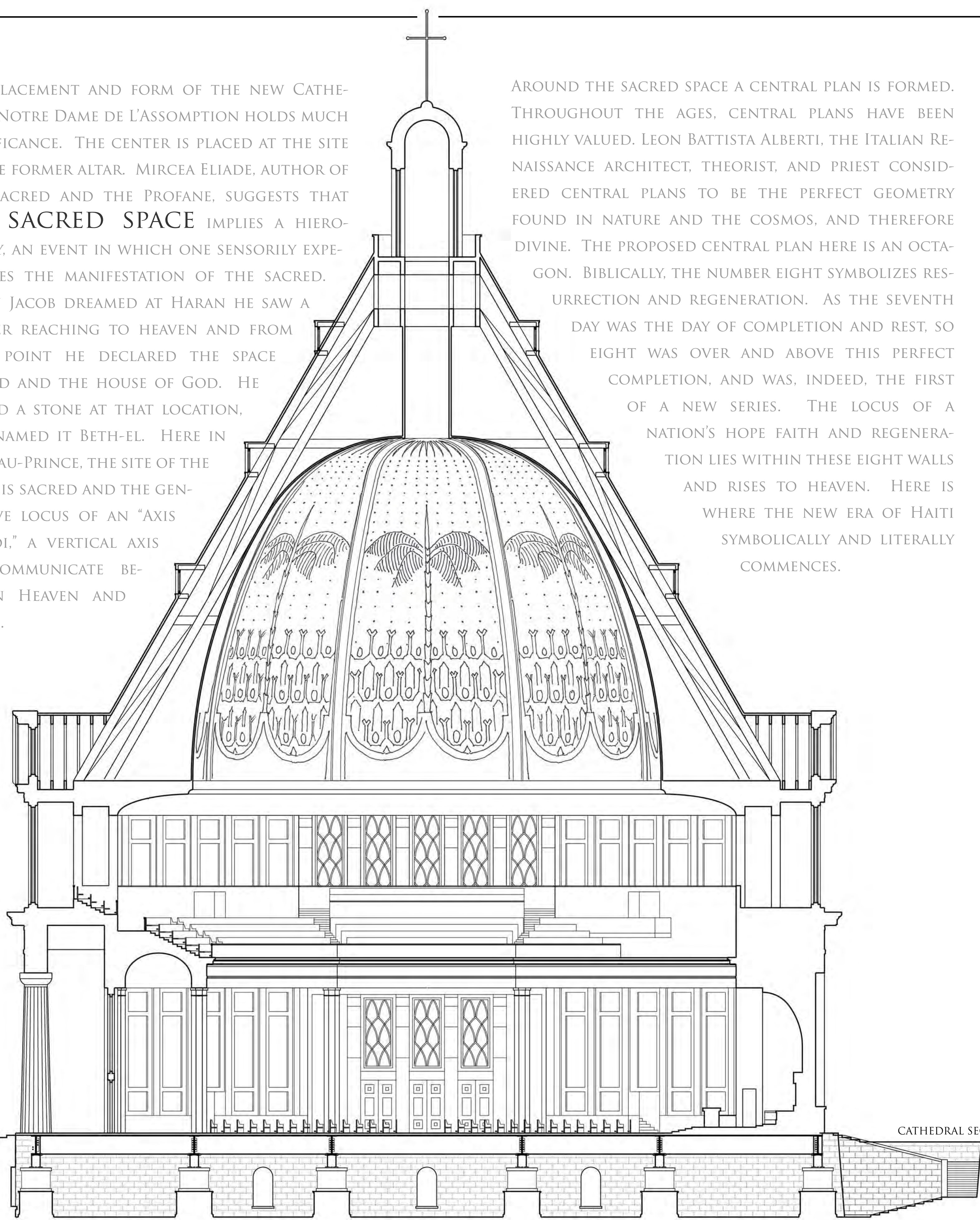

CATHEDRAL SECTION

THE DOME OF THE NEW CATHEDRAL IS SHOWN COVERED IN BEAUTIFUL VERNACULAR FRESCOS. HEAVEN AND THE STARS IN THE SKY ARE LITERALLY DEPICTED, ILLUMINATED BY SMALL PUNCTURES IN THE HUNG PLASTER DOME THROUGH SMALL HOLES THAT TRANSMIT LIGHT BROUGHT INTO THE STRUCTURAL SPACES BETWEEN THE DOME AND THE STRUCTURAL ROOF BY SMALL DORMER WINDOWS. THESE DORMERS, STAGGERED IN ELEVATION HELP ANIMATE A STEEP PITCHED HIP ROOF, COVERED IN COPPER. THE PROFILE OF THE ROOF SUBTLY RECALLS THE FOLKLORIC CHARACTER OF BUILDING FORMS IN HAITI, AND ALLOWS A SPECTACULAR DOME TO BE HOUSED INSIDE. BENEATH THE SKY DOME, SPRINGING FROM THE INTERIOR CROWN ARE COLOSSAL PALM TREES SYMBOLIC OF THE BOUNTY OF NATURAL RICHES IN HAITI. SURROUNDING THE TREES AND ANCHORING THE COMPOSITION OF THE FRESCOS ARE DEPICTIONS OF THE GREAT PEOPLE OF HAITI, WITH ARMS RAISED, READY TO RECEIVE THE GIFTS FROM THE HEAVENS.

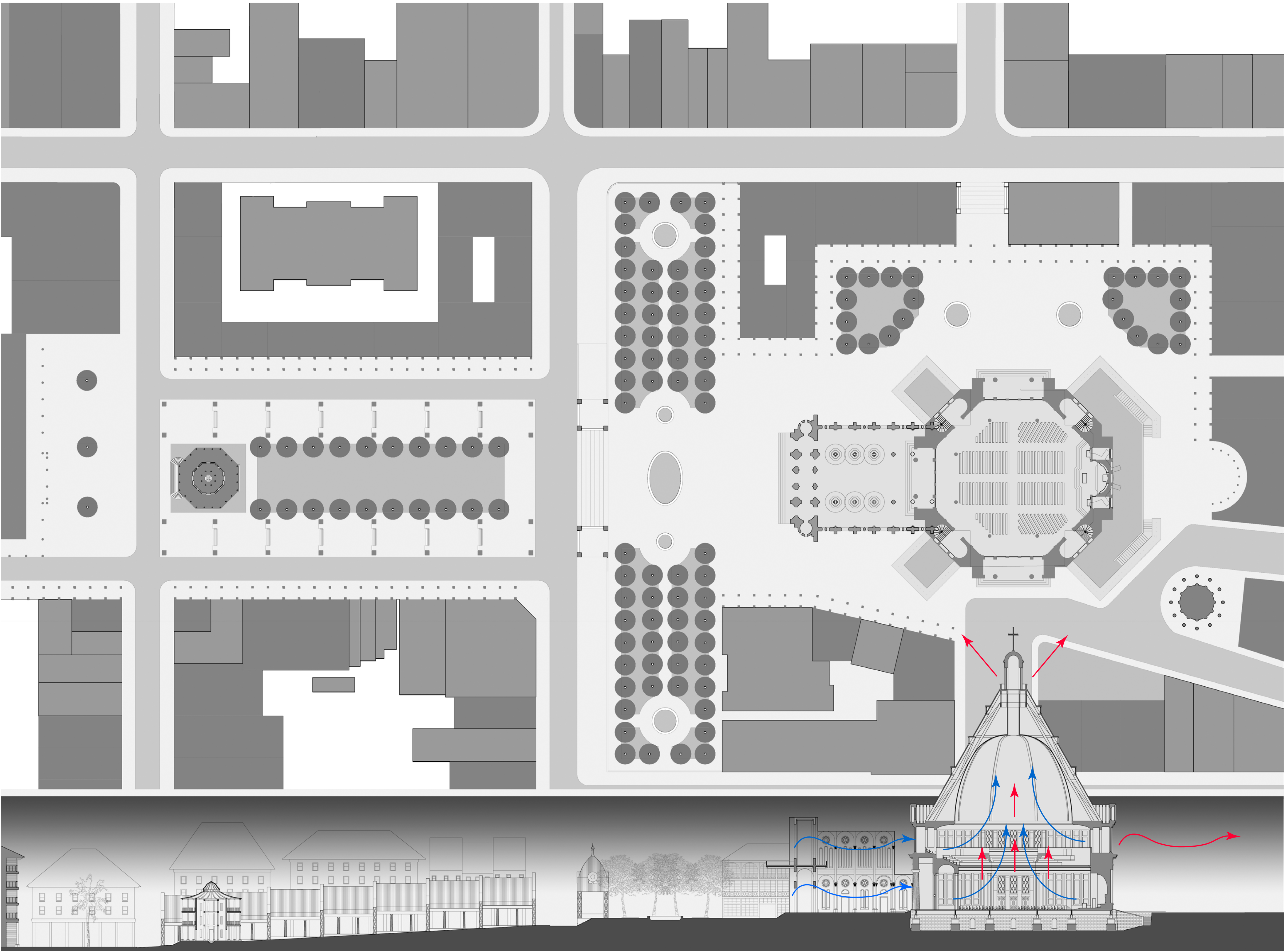

THE DESIGN AND CONSTRUCTION IS A SEED FOR A GREAT VISION. AS THE CHURCH IS BUILT, ALONG WITH THE MEMORIAL, IT WILL FOSTER BELIEF AND CONFIDENCE IN THE MINDS OF ALL HAITIANS. ONCE A BUILDING OF SUCH MAGNITUDE IS CONSTRUCTED, OTHERS WILL FOLLOW. AS SUCH, THE DESIGN OF THE NEW CATHEDRAL INCLUDES AN URBAN PLAN THAT EXTENDS WEST TO THE GULF OF GONAVE. THIS PLAN IS CENTERED ON A CRUCIFORM OF NEW LINEAR PUBLIC SPACES. THE CROSSING, SYMBOLICALLY REFERENCING THE CROSS-AXIS OF THE FORMER CATHEDRAL PLAN, IS MORE FORMAL IN NATURE, AND ALSO MORE GREEN. IT IS PLANTED WITH FLOWERING SHADE TREES AND PROVIDES A TRANSITIONAL SPACE BETWEEN THE HUSTLE AND BUSTLE OF THE CITY AND THE SACRED SPACE OF THE MEMORIAL AND CHURCH. TO THE WEST, A LONG LINEAR SPACE, SYMBOLICALLY THE NAVE, SERVES EFFECTIVELY AS THE NEW CENTRAL PARK, OR PLAZA. IT IS LINED WITH MARKET STALLS, FORMALIZING AN ALREADY COMMON RETAIL PRACTICE OF STREET VENDORS. TO THE WESTERN SIDE OF THE PLAZA IS A NEW BAPTISTERY, PROVIDING A COMPOSITIONAL BOOKEND TO THE PLAZA AND EXTENDING THE REACH OF THE CHURCH. AS DEVELOPMENT OCCURS, IT SHOULD BE SYSTEMATIC AND PLANNED. THE DESIGN PROPOSAL SUGGESTS METHODS BY WHICH THE NEW PLAN COULD OCCUR, WITH MULTI-STORIED HOUSING, PLACED ON SEISMIC ISOLATORS SIMILAR TO THOSE SUPPORTING THE NEW CHURCH. THIS NEW PLAZA COULD BECOME THE NEW CENTER OF PORT-AU-PRINCE AND, AS SUCH, SHOULD BE BUILT UP TO THE DREAMS AND ASPIRATIONS OF THE CITY. PORT-AU-PRINCE WAS DEVASTATED BY AN EARTHQUAKE, BUT MUST MOVE FORWARD. GREAT CITIES ARE BUILT ON THE BACKS OF MEN AND WOMEN, BUT WITHOUT GREAT LEADERSHIP AND VISION, GREAT EFFORT CAN BE LOST. JOHN RUSKIN, AUTHOR OF THE SEVEN LAMPS OF ARCHITECTURE SAID, “WHEN WE BUILD, LET US THINK THAT WE BUILD FOREVER.” SO IS TRUE IN PORT-AU-PRINCE, GOD WILLING.

AT THE HEART OF THE REBUILDING PROCESS IS THE CHURCH. WHEN SO MANY HAVE LOST, AND SO MANY ARE IN SEARCH OF ANSWERS, THE CHURCH REMINDS US THAT WE ARE SURVIVORS. NOTRE DAME DE L'ASSOMPTION STOOD TALL AND PROUD IN THE SKYLINE OF THE CITY, ITS TWIN BELL TOWERS WERE SCALED TO THE SIZE OF THE MOUNTAINS AND THE SEAS. THEY SPOKE TO THE NATURAL WORLD NOT THE MANMADE. SO TOO, IS THE CASE IN THIS DESIGN PROPOSAL FOR A NEW CATHEDRAL FOR A NEW HAITI.

THE DESIGN OF THE NEW NOTRE DAME DE L'ASSOMPTION IS BUILT ON THE FOUNDATION OF THE FORMER. LIKE ST. PETER'S IN THE VATICAN IN ROME, THE SITE OF THE FORMER ALTAR IS NOW AT THE CENTER OF NEW BUILDING. THE FOUNDATIONS OF THE DESTROYED CHURCH ARE GENERALLY PRESERVED, AND WILL LIE UNDERNEATH THE RAISED FLOOR OF THE NEW STRUCTURE. THIS CRYPT OF SORTS IS ACCESSSED BY FOUR SEPARATE STAIRS INTO THE SPACE. THE RUIN BELOW IS LIT FROM THE SIDES. EXCAVATED FOUNDATIONS WILL OFFER EDUCATIONAL AND HISTORIC LESSONS FOR GENERATIONS. THE NAVE OF THE CHURCH WILL REMAIN A RUIN ABOVE THE GROUND. THE SOARING PIERS, ARCHES AND BUTTRESSES ONCE SUPPORTED A GRAND ROOF. THE DESIGN PROPOSAL PRESERVES THE VOLUMETRIC GRANDEUR OF THE FORMER NAVE BY KEEPING THESE VERTICAL ELEMENTS AND REINFORCING THEM TO ENSURE THE SAFETY OF FUTURE VISITORS. THIS FORMER NAVE, AND CURRENT RUIN, ARE MAINTAINED IN THE DESIGN AND TRANSFORMED INTO A MEMORIAL PARK. STONE PLANTERS BUILT AT BENCH-HEIGHT HOUSE NEW SHADE TREES AND TRANSFORM THE HOT, BRIGHT LANDSCAPE INTO A DELIGHTFUL, SHADED SPACE. THE GREAT FAÇADE OF THE CHURCH IS REINFORCED AND PRESERVED, HELPING TO ENCLOSE THIS RUIN MEMORIAL. A NEW STAIR IS ADDED TO THE FAÇADE AS WELL AS A WIDER BALCONY FACING WEST. THIS BALCONY CAN SERVE AS A SPEAKING LOCATION FOR LARGER MASSES. THE PROCESSION REMAINS AS IT ALWAYS HAS: FIRST CROSS THROUGH THE THRESHOLD OF THE FAÇADE BELOW THE ROSE WINDOW, THEN PASS THROUGH THE NAVE, NOW IN RUIN, AND THEN CONTINUE THROUGH THE MONUMENTAL OPENINGS OF THE NEW CENTRALLY PLANNED CATHEDRAL. THE IMPACT OF THIS PROCESSION IS ONE OF HUMILITY. WE WILL NEVER FORGET THE EVENTS THAT HAPPENED ON THE AFTERNOON OF JANUARY 12. THE DESIGN PROPOSAL DOES MORE THEN JUST REBUILD, IT HONORS THE DEAD AND CELEBRATES THEIR MEMORY. THE COUNTRY AND THE WORLD CAME TOGETHER AT THAT MOMENT TO SUPPORT EACH OTHER IN A CRISIS. THE WORST OF DISASTERS BROUGHT OUT THE BEST OF HUMANITY. THERE IS NO BETTER PLACE TO CELEBRATE THIS THAN AT THE FOOTSTEPS OF A CATHEDRAL. RELIGION TEACHES US MANY LESSONS, AND BRINGS COMFORT TO MANY MORE. THE DESIGN OF THE MEMORIAL PARK ATTEMPTS TO EVOKE FEELINGS OF HUMILITY AND OFFERS A COLLECTIVE RESTING PLACE FOR THE SOULS OF THE VICTIMS.

